

# Silent Wall Fans (100mm)



Silent fans are 70% quieter than standard axial fans when operating

Basic and timer control options

Low profile design for wall mounting

Long life, ball bearing motor

## Accessories

### ED1

Easyfix ducting plastic wall liner with integral screw-fixing channels.



### FF100

Fast fix wall duct system. Comprises 100mm PVC duct with external wall duct seal and external grille. Available in white or brown.

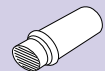

### EG1

Complementary fixed blade louvred grille in semi-matt ABS plastic. Available in white or brown.



### PFA100

Picture frame adaptor in white ABS plastic.



### EWS100

Window mounting kit in white ABS plastic.



### Decorative Covers and Inserts

Decorative covers and inserts as per page 19.



## Physical Specifications

**Weight:** SR100 – 0.63kg

**Material:** ABS plastic

## Dimensions

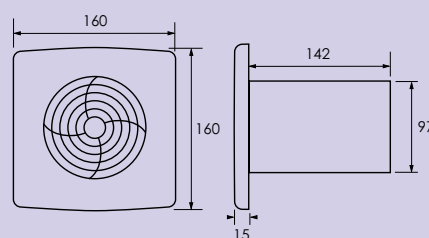

## Performance Graph

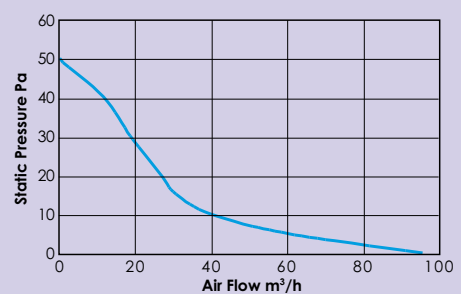

## Electrical Specifications

230V~50Hz class II

**Consumption:** 100mm fan – 13W

**Cabling:** 2 core: 1mm² max.  
3 core: 1/1.5mm² max.

## Data Table

	Performance in free air		Sound Pressure level @ 3m	IP Rating	Operation	Features
	m³/h¹	l.s¹	dB(A)			
SR100	95	26	26.7	44	Single speed	100mm basic fan. Remote operation
SR100TR	95	26	26.7	44	Single speed	100mm timer fan. Remote operation
SR100HTR	95	26	26.7	44	Single speed	100mm humidistat fan. Remote operation